



YTLock

Product specification

5-Inch Dynamic Face Recognition Machine

Specification Parameter

Name	5 Inch face recognition access control machine
Processor	Dual-core A7 32-bit RISC CPU 1.0 GHz
DDR	DDR3 128M Byte
Built-in storage	SPI NAND 128M Byte
Display screen	5-inch 480 x 854 IPS display, touch support
Camera	Binocular 1.3 million pixels, support wide dynamic, support intelligent FACE AE
Portrait library	5000
Recognition rate	≥99.7%
Recognition speed	≤200ms
Recognition distance	0.3-2.0 meters
Management platform	Supports local platform and cloud platform management
Face registration mode	Device local registration, U disk batch picture registration, local platform delivery, cloud platform delivery
Traffic record	100,000 records
Output mode	Wiegand 26/34/, relay output, lock interface output
Communication interface	One USB2.0
Opening mode	Exit button, password, swipe card, face recognition, APP remote door opening
Access control interface	1 relay output, doorbell interface, Wiegand 26/34, drive lock interface, exit button
Lock drive current	Supports a maximum of 12V/4A
Power supply	12V/1A
Work loss	≤12W
Operating temperature	-30°C ~ +80°C(no condensation)
Working humidity	0%—90%
Outdoor protection	Outdoor rain protection

User management

Add a user

ID: Employee number or user number, this field is required

Name: Successful name or nickname recognition is displayed on the screen

Limits of authority: Common user or administrator

Card Number: Enter the card number input interface, swipe the IC card, NFC mobile phone to input the corresponding card number

Face recording: Add user face

User management

Open the user list to see all the people who have registered, Users can be edited, modified, and deleted

Communication setup

WiFi Settings: Add or remove WiFi

Add an administrator: APP add device, scan the QR code below to add as administrator

Network Settings: The network IP address can be set

Wiegand setup: Wiegand output format and Wiegand output content can be set

U disk management

【 Export attendance records 】 To export attendance records, you can use the export tool to generate attendance reports. For details, see the description of exporting to the U disk.

【 Export device fault logs 】 Insert the USB flash drive and click “Device Fault Log Export” to export the device fault logs to the USB flash drive

【 Usb flash drive upgrade 】 The firmware file of the device to be upgraded is copied to the root directory of the USB flash drive and inserted into the USB flash drive upgrade to start the software update. After the update is completed, the USB flash drive needs to be removed and restarted.

System setting

Time and date: Time and date can be set

Password setting: Menu password and door opening password can be set (default menu password: 123456)

Face parameter: Can set the recognition distance, live recognition, face threshold, etc

Language setting

Protection management: Open mask detection, allow unregistered people to pass, open the door delay

Restore factory Settings: Click this button to initialize the device.

To restart the device: Click here to restart the software.

Access control wiring

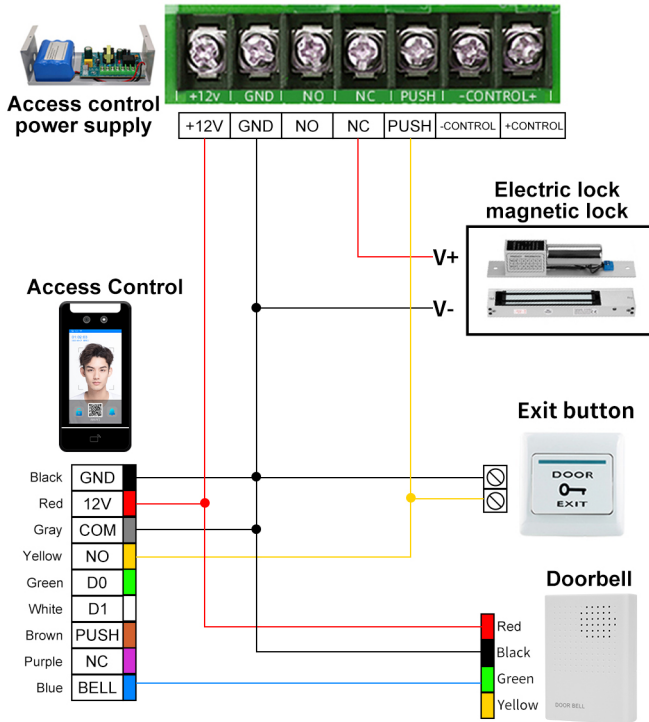

YTlock Smart APP

1 Search for "YTLock" in the app store to download it.

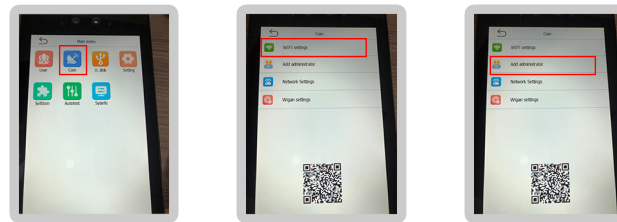
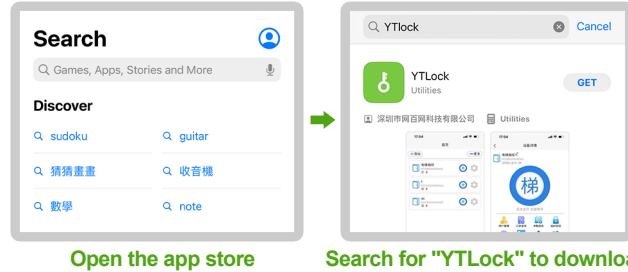

1. Double-click the screen to enter the menu, Click "Com".
The default common password is 123456
Default password: 7890
2. Click "WiFi Settings" and distribution network (4G/TCP can skip this step) After the access control device is successfully configured, return to the "Com" page
3. Click "Add administrator", and open the APP code scanning device binding

2 Open the "YTLock" APP, register and log in, Enter the APP and click "Add", Click "Add manually"

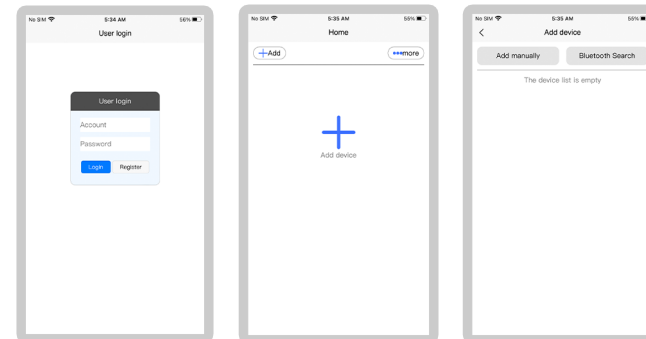

3 The device returns to the "Com" page. Click "Add administrator", Enter the device name, Mac address, scan the QR code on the device, and Click "Add". Return to the home page of the APP and click "Key" to open the door remotely.

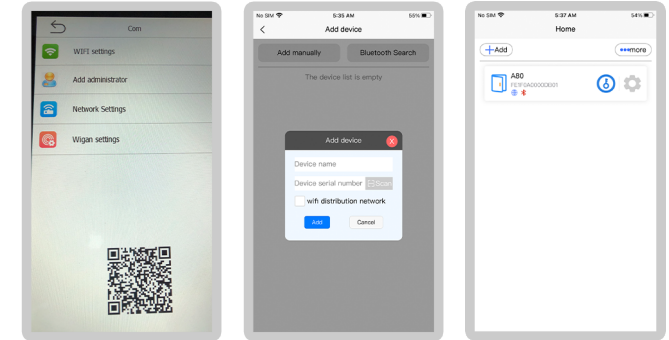

4 Click Set Manage Device, Click "User Management" to manage users, Click "Add User" to add a new user, Select "User Type", enter the user name, and click "Add". Click an added user to modify the user information.

